

MD70MH General Specification.

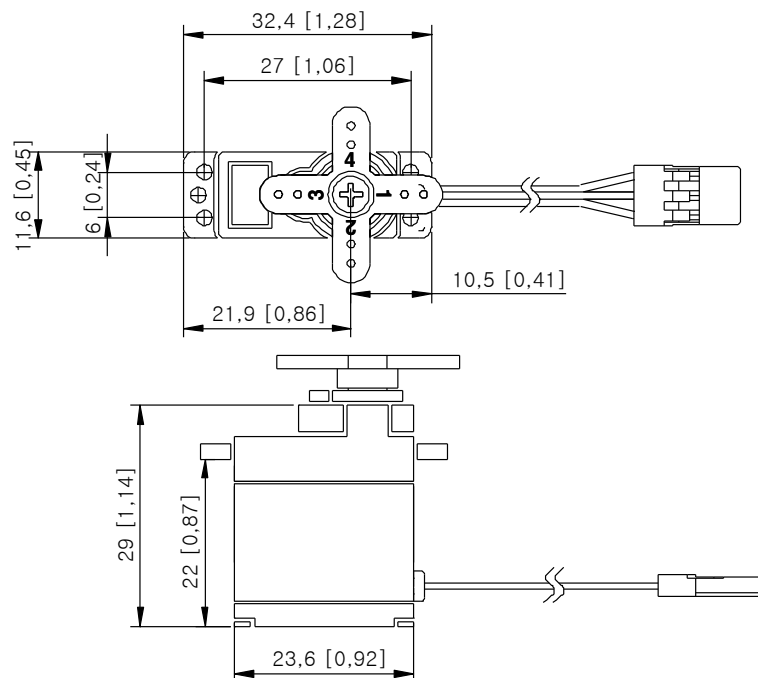

INDUSTRIAL SERVO

Control system	PWM		-
Position sensor type	Contactless Magnetic Encoder		-
Operating voltage range	6.0 ~ 7.4 V		-
Motor type	Cored		-
Voltage	-	6.0 V	7.4 V
No load speed	-	0.15sec/60°	0.12sec/60°
Stall torque	-	3.1 kgf·cm(43.05oz·in)	3.8 kgf·cm(52.77oz·in)
Standing current	-	30mA	30mA
No load running current	-	200mA	240mA
Stall current	-	1000mA	1300mA
Dead band width	-	2usec	2usec
Operating travel	Default : ±40°/1,100~1,900usec / ±60°/900~2,100usec		-
Operating temperature range	-20°C ~ +60°C (-4°F ~+140°F)		-
Vibrations at no load	MIL-STD-810G 514.6C-VII		-
Storage temperature range	-30°C ~ +80°C (-31°F ~+176°F)		-
Connector wire length	160mm(6.3 inch)		
Connector wire gauge	24AWG		
Dimensions	23.0 mm x 11.6 mm x 30.0 mm(0.91inch x 0.5inch x 1.18inch)		-
Weight	14.1 g(0.5 oz)		-
Ball bearing	1 Ball Bearing		-
Case material	Engineering plastic		-
Gear material	1 Resin & 4 Metal Gears		-
Gear train backlash	Max 0.5°		-
Horn gear spline	M25T(25 Segment Ø5.0)		-
IP rating	-		-
Servo Amplifier type	32bit programmable Digital		-
Features			-
Applications			-



1:1 scale (unit : mm)

- This product should not be used directly on the human body for medical purposes.
- Do not use for war weapons.
- All specifications are subject to change without notice.



<https://hitec.com>